

## Sovereign Harbour Entrance Channel

### Notification of Maintenance Dredging Operations & dredger sailing route exclusion area

Maintenance Dredging operations are due to commence at Sovereign Harbour on or around Wednesday 2<sup>nd</sup> April 2025. To facilitate safe and efficient navigation of the dredger to and from the dispersal site **all fishing vessels are instructed to keep the dredger's sailing route free of gear and obstructions**. Further notices will be issued notifying of buoyage removal within the entrance channel.

**Mariners are advised to give the dredger 'Sospan Dau' a wide berth when passing, especially within the outer harbour.**

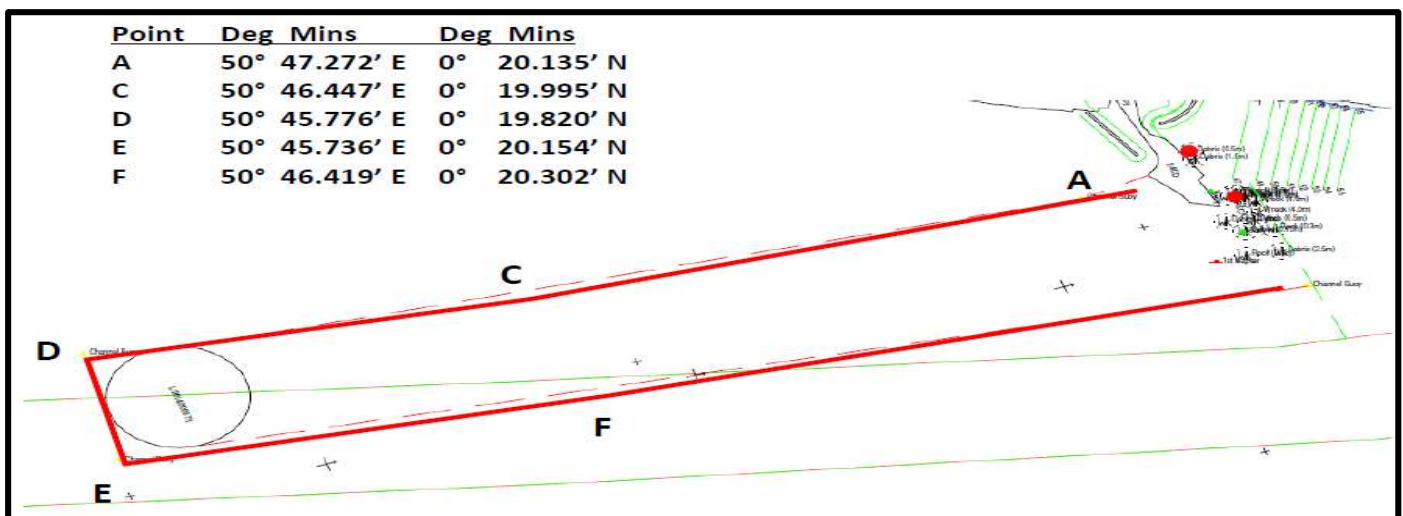

Points above will be marked by round bufs.

Mariners may contact  
**'SOVEREIGN HARBOUR'**  
On VHF Channel 17 for further information

The Harbour Office can be contacted (24hrs)  
VHF Ch.17, by telephone (01323 470099) or via email at [eastbourne@premiermarinas.com](mailto:eastbourne@premiermarinas.com)  
**Premier Marinas (Eastbourne) Ltd**

Amy Walker – Duty Manager

Issued: 21/03/2025 11:15hrs